



THE STORY

In early 1993, DOD Electronics was split between two locations in Murray, Utah, comprising a Riley Lane main office and manufacturing facility and a Vine Street engineering office and secondary manufacturing facility. In March of that year, we consolidated operations into one large 100,000 square foot building in Sandy, Utah. During that year of significant company expansion, we hired Rick Kreifeldt, a freshly-minted engineering graduate and guitarist who specialized in Digital Signal Processing (DSP) in college and quickly developed into a key employee and talented engineer. About that same time, we also hired Billy Clements, who likewise provided huge value to the company for decades as a talented guitarist with a great ear for tweaking effects and a knack for user interface design and product definition. As young single rocker dudes, Rick and Billy became fast friends and decided to rent a bachelor hangout house.

Just prior to this timeframe, Utah liquor laws had changed, loosening up restrictions on home brewing, so Rick and Billy thought they'd try their hand at concocting their own potions, securing the needed supplies and expert advice from The Beer Nut, a local Salt Lake City home brew establishment. As brewing is a bit analogous to cooking, in the many requisite brewing hours spent "slow cooking" in the kitchen, they and other friends spent time just hanging out and talking about music and anything and everything. A lot of great product ideas came about from these after-hours hangout sessions. During this socializing, they raised the idea of hosting a home brew party for friends and fellow home brewers. This turned into an annual beer and pot luck event for about the next 6 years. Home brewer friends would bring their own custom brews and potluck dishes, while Rick provided the burgers. Billy decided they needed to create an invitation poster for their home brew party. In the process of designing a poster, he determined he needed a name for their own particular "brand" of brew. Being a fan of the Curious George books, he decided on "Bad Monkey Brewery", envisioning a somewhat more mischievous (twisted?) version of George, the curious monkey. It became customary to emphasize and draw out the word "bad" when referring to the brand, as in "BAAAAAD monkey!" Using his artistic skills, Billy designed the Bad Monkey Brewery logo, igniting the creative spark for this fun bit of DOD history. Incidentally, Rick & Billy provided their own Bad Monkey beer for Rick's wedding.



Not long after this, just past the "turn of the century" – that sounds funny in this context – Harman corporate folks decided that Harman Music Group had "too many brands" and insisted that the DOD® brand go away in favor of the stronger DigiTech® brand. Yet there was still a demand for the pedals that DOD® had thrived on for the prior 25 years. To be in compliance with the zoo keeper's wishes, the DOD® brand was shelved and some of the more popular DOD® pedals were shifted under the DigiTech® umbrella and rebranded as such, most notably the Grunge® and Death Metal™. Around same time, in 2004, hardware engineer Chris Haun and talent designed three new analog distortions to be branded as DigiTech®. One of those designs was a Tube Screamer-style distortion, and the engineering and marketing teams kicked around various proposed names for the pedal, as is typical in our product development process. Ultimately, it was Billy's suggestion that we call it the "Bad Monkey Overdrive" that won the vote. Screamin' Blues™, Hot Head™, and Bad Monkey™, all housed in the new DigiTech® "X Series" chassis, joined the Grunge® and Death Metal™ in this new DigiTech® series. While some felt that forcing these purely analog circuits into the DigiTech® brand was a bit of "a square peg in a round hole", DigiTech® already had a rich history of producing great-sounding analog distortions, albeit digitally controlled, so it wasn't a complete stretch for the brand. This X Series of analog distortion pedals did quite well in the market, especially the Grunge® and Death Metal™, but the Bad Monkey™ certainly held its own for many years at a compelling U.S. retail price of \$69.95. For more than a decade, the Bad Monkey™ continued to be a solid seller. Interestingly, in mid-2012, a company party was held at a local bowling alley to honor DOD® founder and former DOD®/DigiTech®/Harman Music Group president, John Johnson. For this party, playing on the Bad Monkey™ popularity, special bowling shirts were designed and produced for the event, emblazoned on the back with a cool "Bad Monkey Bowling Club" logo, and all employees received a shirt. Sadly, in 2015, in an effort to streamline the product line, Harman permanently discontinued the Bad Monkey™.

Fast forward to Mar 13, 2023, Josh Scott of JHS Pedals inadvertently caused the used market for Bad Monkey™ pedals to explode by releasing an entertaining YouTube video playing on the monkey and banana theme and extolling the virtues of the Bad Monkey™ pedal by comparing its sound to the Ibanez TS-10 Tube Screamer, the Klon Centaur, and other well-respected vintage overdrives that were currently selling for many hundreds, if not thousands of dollars on the used market. The gist of the video was that the Bad Monkey™ was versatile enough that you could get the same – virtually indistinguishable – sounds from a used Bad Monkey™ as these oth-

er highly-respected pedals at a fraction of the cost – still in the same ballpark as their original \$69 retail price! Naturally, from viewers responding to the JHS video, the Bad Monkey™ asking prices skyrocketed to as high as \$600 or more! However, due to the general availability of Bad Monkey™ pedals in the used market, it didn't take long for the prices to cool back down to more sane levels, and as of this writing can be had in the range of \$100-\$200, depending on its condition. Those in excellent condition, of course, sell for much more. Since that video in 2023, the "howls" for a Bad Monkey™ reissue have been loud and unceasing. We would like to say that we've heard and responded to those voices, but the fact of the matter is that we had already been planning to release a next-gen Bad Monkey™ long before all this hub-labaloo. However, in principle, we generally don't do "reissues". We ALWAYS have to "up the ante".

So, how exactly did we up the ante on a next-gen Bad Monkey™? Well, the first order of (monkey) business was, at a minimum, to at least make sure you get exactly what you asked for – the Bad Monkey™. Just like it was with its same overdrive circuit, gain range, and EQ frequencies, but appropriately relabeled "Grunt™" for the low-end EQ and "Screech™" for the mid-high EQ. And Bananas™ for gain™ that replicates the range of the original control, as well as Curiosity that signifies your "level of Curiosity™", like the original output Level control. Now, just that would have gratified the masses. But that didn't really excite us. Too obvious. Too...predictable. OK, so what if we threw in another circuit too – a "badder" overdrive, so you could go totally "bananas", if that's your thing! So, a second completely separate overdrive signal path? Yeah, that's cool! Two pedals for the price of one! But, hey, why stop there? Maybe you don't wanna go totally bananas. So, how about if we also throw in a third – a bit more subtle – overdrive circuit too? More "behaved", you might say. Three completely separate overdrive signal paths? Three unique pedals in one box? Take my money! But hang on – since we're getting crazy now, how about a toggle to switch between the overdrives? Interesting, but...it just wasn't doing it for us. Again, too...predictable. OK, so what if the toggle could switch the distortion paths in parallel? OK, keep talking, I'm listening... Well then, how about something even better? How about a new (patent-pending) 360-degree "Barrel Control™" that enables parallel blends of overdrive paths? Wondering how well a bad monkey gets along with a really bad (badder) monkey? You can easily find out by turning the Barrel Control™. Or how a badder monkey contributes to the delinquency of a behaved monkey? Turn the Barrel Control™. Get it? There's a whole barrel of monkeys in there! (And a commensurate diversity of primate personalities all along the behavioral spectrum.) It's sort of a "circle of life" thing, or something like that! This really cool (patent-pend-

ing) blending Barrel Control™ provides unparalleled (well, actually paralleled) tonal flexibility! And, while we're talking barrels, why wouldn't the Barrel Control™ knob be an actual barrel? And why not a barrel straight from the Bad Monkey Brewery? What else would you expect? And you might notice that the knob pointer just happens to be the index finger of the Badder Monkey™ as it's a bit too confining in there and he raises the lid of the barrel to escape.

You say that this is three pedals for the price of one. But what if I'm perfectly happy with just one of the three overdrive sounds? Like just the Behaved™ sound? Or just the Bad Monkey™ sound? Easy. The Barrel Control™ has three detented (click) positions associated with the Behaved™, Bad™, and Badder™ circuits. When the Barrel Control™ is set to one of those detent positions, only that single overdrive path is active. Cool. But let's say I'm a little crazy and want ALL three overdrive circuits at once. I want the WHOLE group of monkeys! (Gaggle of monkeys? Horde? Throng? Multitude? Ensemble?) Hey, what the heck is a group of monkeys called anyway? We looked it up. The proper term is a "troop" of monkeys. Well, there you go. The middle position on the toggle switch is labeled "Troop™". So, switching to Troop™ mode configures all three overdrive circuits to be mixed evenly in parallel. Switch to Troop™ mode to experience the chaos of all three monkeys in the barrel!

At this point, you'd think that we already packed in enough features, but we just couldn't stop monkeying around. Check out the other two functions on that 3-position toggle switch. Notice the right-side-up and upside-down Bad Monkey™ icons. This switch allows you to either blend the Bad Monkey™ overdrive circuit in phase with the Behaved™ or Badder™ overdrive circuits (with the switch in the up position), or blend the Bad Monkey™ overdrive out of phase with them (with the switch in the down position), further enhancing the tonal variety from this pedal. You can get some really interesting monkey-quarreling, poop-flinging phase cancellations resulting in unique (and even fukk-like) sounds at particular Barrel Control™ blend settings.

All told, this new Badder Monkey™ blows away all expectations of any ordinary Bad Monkey™ reissue right out of the water! (Or, maybe to avoid mixed metaphors, right "off the vine"?) You might add that the icing on the cake (dang – another mixed metaphor) is the imaginative graphic design, not to mention a tri-color effect/mode LED, and a horde (troop?) of "swag" included in the box – stickers, guitar picks, a Bad Monkey Brewery beer bottle label, and a collectible barrel of monkeys keychain that doubles as a guitar pick holder! We really went bonkers to make this release wacky and memorable! We've even included a Cage-Free sticker so you can join

the entire DOD®/DigiTech® troop in once again celebrating the free spirit and vibe of DOD® – America's Pedal™! (And the liberation of primates in general – cheeky ones in particular.)

Exhausted yet? Well, we didn't stop there! Introducing, and debuting on the Badder Monkey™, is the brand-new patent-pending StagePlate™! Check out that bottom plate. It's reversible! Remove the four bottom plate screws and flip the StagePlate™ over to reveal a pre-attached "hook and loop" pad (some call it Velcro®) for immediate attachment to your pedal board! Gone are the days of gumming up, compromising, and immediately lowering the resale value of your pristine new pedal with aggressive hook-and-loop adhesive and its inevitable disgusting gummy residue! And another nice bonus – with the StagePlate™, the product labeling and serial numbering are still intact and easily visible on either side.

The Badder Monkey™ has escaped! (You know, you really can't cage a Badder Monkey™). In this new "Cage-Free" era of DOD®, we are so stoked to get this pedal in your hands. It's an instant classic! Check out the numerous sounds you can get with this amazingly versatile overdrive in our Example Settings section of this manual. And check out the myriad of (gorilla marketing?) videos available on the internet to see how your fellow musicians are swingin' with and diggin' this amazing pedal! Anyway, enough with the puns. The tone – the flexibility – the features – the vibe – the value – the monkey mayhem – are incredible! You won't be disappointed! Oh, and by the way, yes, we know that technically the Badder Monkey™ is not a monkey – he's an ape. But who's obsessing over details? (Usually me.)

Anyway, stay curious, my friends!

Josh Scott

Roger Johnsen
VP of Engineering
6 OCT 2025



FEATURES

Though the re-release of a Bad Monkey has been loudly demanded by fans across the world, and fans would have been sufficiently satisfied by a simple reissue, the Badder Monkey™ is far more than that. The world has never seen an overdrive like the Badder Monkey™! It not only includes a faithful reproduction of the original circuit and sound but far exceeds its predecessor in features and versatility. From its three completely independent Behaved™, Bad™, and Badder™ overdrive circuits giving you three pedals in one, to its unique parallel blending enabled by the patent-pending Barrel Control™, further enhanced by optional out-of-phase combinations, to the all-three-in-parallel Troop™ mode, the Badder Monkey™ represents unheard-of variability in an affordable compact overdrive pedal! Also included is the new patent-pending reversible StagePlate™ with both a rubber skid pad side and a "hook and loop" side for clean and convenient pedal board mounting.

- 3 independent overdrives in 1 pedal!
- Replicates the original Bad Monkey™ circuit
- + NEW higher-gain Badder™ overdrive circuit
- + NEW lower-gain Behaved™ overdrive circuit
- Grunt™ (Low) & Screech™ (Mid-High) cut/boost Mood™ EQ
- + NEW Patent-Pending Barrel Control™ for blending overdrives
- Overdrives can be used independently or blended in parallel
- Troop™ mode blends all 3 overdrives in parallel
- Bad Monkey™ phase invert function for increased blended tonal variety
- Triple-gang Bananas™ (Gain) control
- Curiosity™ (Output Level) control
- + NEW Patent-Pending reversible StagePlate™ with skid pad on one side & hook-and-loop on the other side for clean & convenient pedal board mounting
- Tri-color LED indicates blending mode
- Standard +9V DC tip-negative barrel jack
- Optional 9V "baddery" operation
- True Bypass

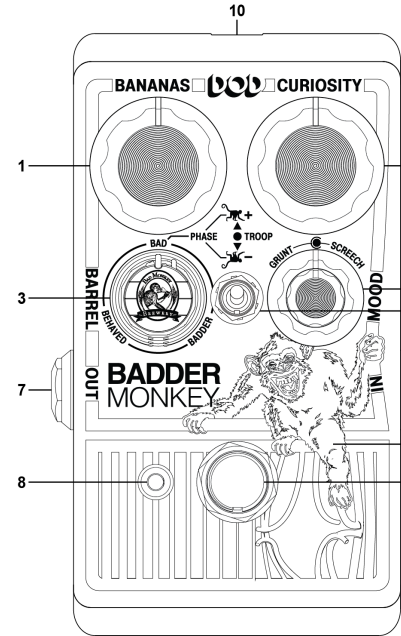

CONTROL DESCRIPTIONS

- 1. BANANAS™ (Gain) Control:** Controls the amount of overdrive/distortion from a mild overdrive when turned fully counterclockwise to full-on distortion when turned fully clockwise. Note that this knob simultaneously controls the gains of all three independent (Behaved™, Bad™, Badder™) overdrive circuits.
- 2. CURIOSITY™ (Level) Control:** Controls the output level of the pedal from completely muted when turned fully counterclockwise to maximum signal level when turned fully clockwise.
- 3. BARREL (Blend) Control™:** Controls the mix of the three independent parallel overdrive circuits. This blends any two of the three parallel overdrive circuits, allowing 1) a Behaved™ / Bad™ mix, 2) a Bad™ / Badder™ mix, or 3) a Badder™ / Behaved™ mix. Also note that this BARREL Control™ has stop positions ("detents") at the Behaved™, Bad™, and Badder™ marks around the knob. At these stop positions, only that particular overdrive circuit is active, allowing you to utilize the pure tone of a single overdrive circuit, if desired.
- 4. MOOD™ (EQ) Controls:** Control the cut/boost levels of the 2-band equalizer. This EQ is post-distortion, so it is shared by and affects all three overdrive circuits. The center detent positions of these knobs means no boost or cut (flat EQ). **GRUNT™ (Low EQ) Control:** Controls the level of the low-frequency equalizer band, providing +/- 22dB of boost/cut centered at 100 Hz. **SCREECH™ (Mid/High EQ) Control:** Controls the level of the mid/high-frequency equalizer band, providing +/- 12 dB of boost/cut centered at above 3 kHz.
- 5. BLEND MODE TOGGLE SWITCH:** 3-position toggle that switches between two variable blend modes where the BARREL Control™ is active and a TROOP™ fixed blend mode where the BARREL Control™ is bypassed. In the two variable blend modes, the BARREL Control™ functions as described in bullet point 3 above. Blend (BARREL Control™) modes are active when the toggle switch is in the upper or lower positions. In the upper switch position (indicated by an upright Bad Monkey icon), the Bad™ overdrive circuit is in phase with the Behaved™ and Badder™ circuits when mixed by the BARREL Control™. In the lower switch position (indicated by an inverted Bad™ Monkey icon), the Bad™ overdrive circuit is out of phase with the Behaved™ and Badder™ circuits when mixed by the BARREL Control™.

This out-of-phase mode induces phase cancellation of various frequencies, resulting in additional tonal variety in the blended overdrive sounds. Finally, in the middle switch position, the BARREL Control™ is bypassed (inactive) and the three parallel overdrive circuits are blended evenly (with all three signal paths in phase), resulting in further tonal variety with rich harmonic content.

- 6. INPUT:** Connect your instrument or the output of another pedal into this 1/4" phone jack.

- 7. OUTPUT:** Connect from this 1/4" phone jack to the input of your amplifier or to the input of another pedal.

- 8. LED INDICATOR:** This 3-color LED lights up when the effect is active. In the upper toggle switch position (Bad™ overdrive in phase), this LED is blue. In the lower toggle switch position (Bad™ overdrive out of phase), this LED is teal. In the middle toggle switch position (TROOP™ mode), this LED is green.

- 9. FOOTSWITCH:** This True Bypass footswitch turns the overdrive on or off. True Bypass means this footswitch enables a direct hard-wire connection between input and output jacks, removing all pedal circuitry from the signal path.
- 10. POWER SUPPLY CONNECTOR:** Connect a power supply (optional) to this 2.1mm center (tip) negative DC barrel jack. Alternatively, install a high-quality 9V alkaline "baddery" by removing the 4 bottom plate screws. Note that plugging a power supply into this connector overrides and disconnects the internal 9V "baddery".

- 11. BADDER MONKEY:** 'Nuff said.

Note: The Badder Monkey™ is tolerant of power supply voltages as high as +18V.

Note: When using a "baddery", remember to unplug the input cable from the Input connector when not in use! The input cable essentially acts as the "baddery" power switch and powers the pedal only when the input cable is plugged in. But that also means that when running the pedal on "baddery", the pedal is always draining the "baddery" any time the input cable is plugged into the pedal. (But, then again, who uses "badderies" these days?)

USING THE StagePlate™

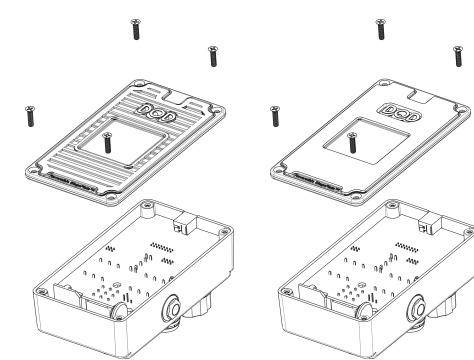

Skid Pad Side: The pedal ships with our new (patent-pending) 2-sided StagePlate™ installed, with the rubber skid pad side exposed when shipped. This provides stable grip on most surfaces when activating the footswitch. **"Hook" Side:** The StagePlate™ can be flipped over to expose the opposite side which has a pre-installed "hook" pad intended to mate with the "loop" material which is a standard means of mounting pedals securely to a pedal board. "Hook and Loop" is the generic term for what is commonly referred to by the trade name Velcro®. To flip the StagePlate™ to the hook side, simply remove the four StagePlate™ screws, flip the StagePlate™ over, then reinstall the screws. Be careful as you're removing and reinstalling the StagePlate™ not to damage the electronic components on the bottom side of the circuit board either mechanically or by static discharge.

PLACEMENT OF THE BADDER MONKEY™

Most guitarists and bassists will favor placing the Badder Monkey™ at the beginning of their signal chain of effects pedals, so start with that placement. A common effects signal chain will consist of overdrive/distortion ("dirt") effects first, followed by modulation effects (chorus, flanger, phaser), and finally longer-time-based effects (delay, reverb, etc.). Other up-front effects can include a compressor, gate, pitch shifter, etc. While this order of pedals in the chain is typical, don't be afraid to experiment with different placements. Also, you might want to try "stacking" more than one "dirt" pedal – meaning connecting the output of one overdrive/distortion pedal into another.



CONTROL SETTINGS

Start with a medium gain position with the BANANAS™ control at the 12:00 position – its midpoint. Also set the CURIOSITY™ output level control to its 12:00 position. Set the MOOD™ EQ controls to "flat", meaning both the large outer GRUNT™ (low) control and small inner SCREECH™ (mid-high) control are set to their "detented" positions at 12:00. In this "flat" EQ position, no low or mid-high cut or boost will be applied to the overdriven signal. Now, select a single overdrive by setting the BARREL Control™ to one of its detented positions. For example, the 12:00 detent position selects only the Bad Monkey™ overdrive circuit. From here, change the BANANAS™ (gain) setting counterclockwise to get a less gain or clockwise to get more gain. Experiment with the GRUNT™ and SCREECH™ EQ settings. Now compare that sound to the Behaved and Badder overdrives selected at their detented positions on the BARREL Control™, or try blending overdrives with the BARREL Control™ set to intermediate positions between the detents. Then listen to what happens when blending Bad™ with either Behaved™ or Badder™ and you flip the toggle switch to invert the Bad™ overdrive. Finally, compare those sounds to when the toggle switch selects TROOP™ mode with all three overdrives in parallel. Remember that TROOP™ mode disables the function of the BARREL Control™.

EXAMPLE SETTINGS

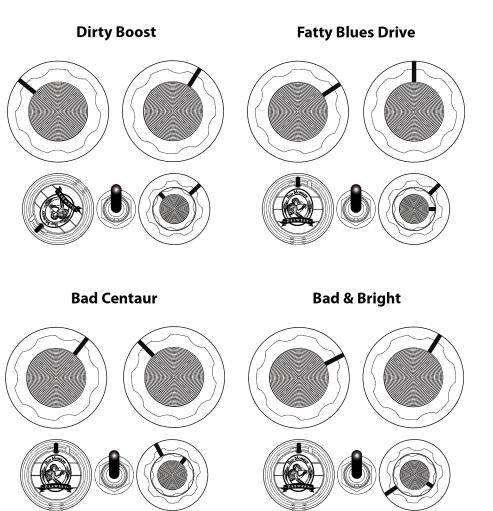

EXAMPLE SETTINGS

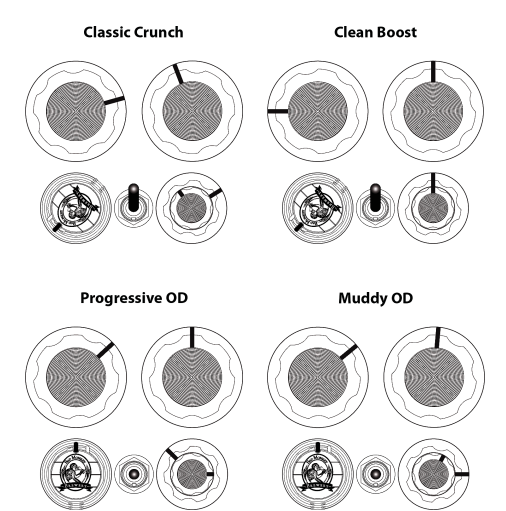

EXAMPLE SETTINGS

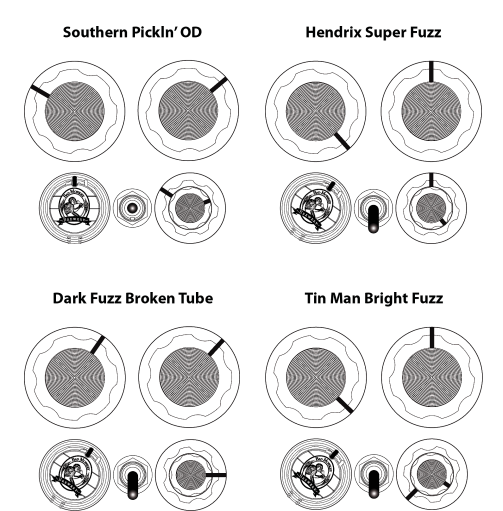

EXAMPLE SETTINGS

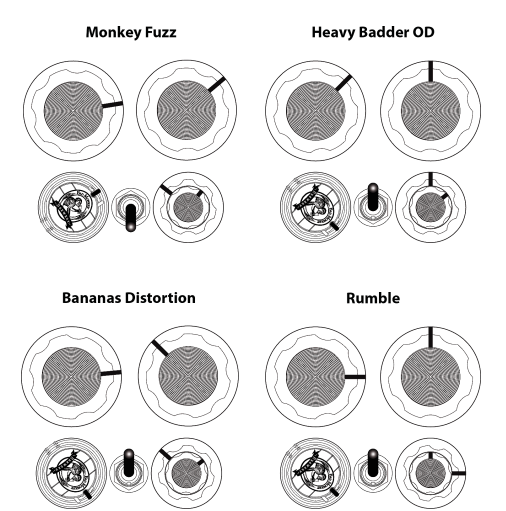

EXAMPLE SETTINGS

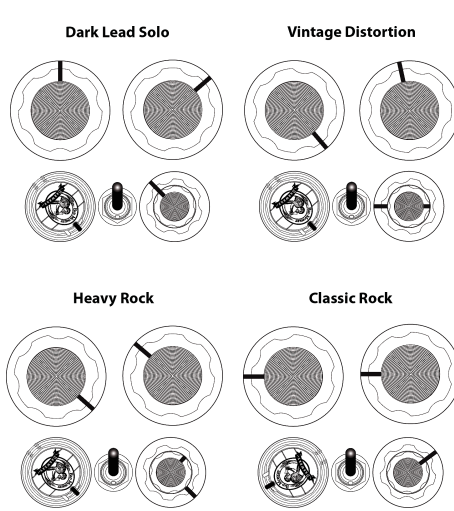

EXAMPLE SETTINGS

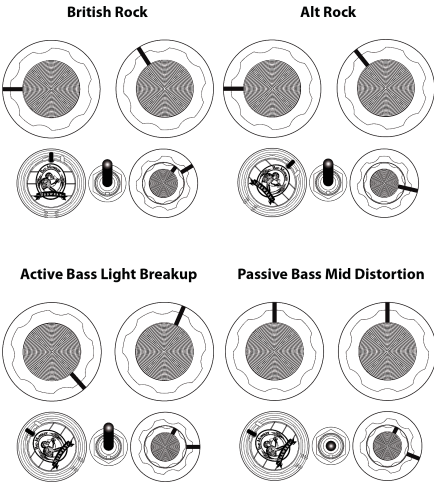

EXAMPLE SETTINGS

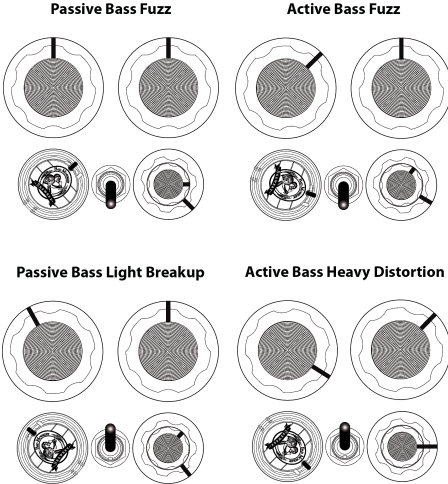

WARRANTY & REGISTRATION

We at DigiTech® are very proud of our products and back up each one we sell with the following warranty:

- Please register online at www.digitech.com within ten days of purchase to validate this warranty. This warranty is valid only in the United States.
- DigiTech warrants this product, when purchased new from an authorized U.S. DigiTech/DOD dealer and used solely within the U.S., to be free from defects in materials and workmanship under normal use and service. This warranty is valid to the original purchaser only and is non-transferable.
- DigiTech liability under this warranty is limited to repairing or replacing defective materials that show evidence of defect, provided the product is returned to an authorized DigiTech/DOD location, where all parts and labor will be covered up to a period of one year from date of purchase. The company shall not be liable for any consequential damage as a result of the product's use in any circuit or assembly.
- Proof-of-purchase is considered to be the responsibility of the consumer. A copy of the original purchase receipt must be provided for any warranty service.
- DigiTech reserves the right to make changes in design, or make additions to, or improvements upon this product without incurring any obligation to install the same on products previously manufactured.
- The consumer forfeits the benefits of this warranty if the product's main assembly has been tampered with by anyone other than a certified DigiTech technician (not including user replacement of the battery) or, if the product is used with voltages outside the range specified by DigiTech.
- The foregoing is in lieu of all other warranties, expressed or implied, and DigiTech neither assumes nor authorizes any person to assume any obligation or liability in connection with the sale of this product. In no event shall DigiTech or its dealers be liable for special or consequential damages or from any delay in the performance of this warranty due to causes beyond their control.

NOTE: The information contained in this manual is subject to change at any time without notification. Some information contained in this manual may also be inaccurate due to undocumented changes in the product since this version of the manual was completed. The information contained in this version of the owner's manual supersedes all previous versions.



MUSEUM OF MODERN MONKEY ART
MoMMA



REPLACEMENT PARTS

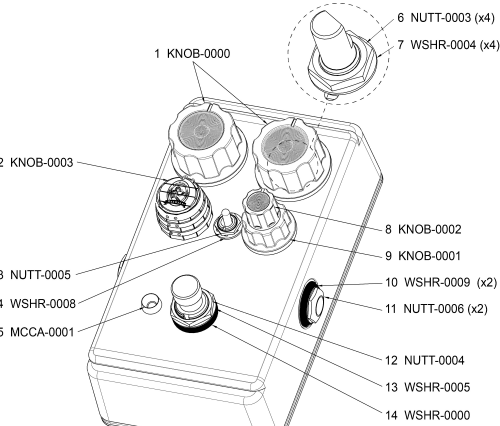

REPLACEMENT PARTS

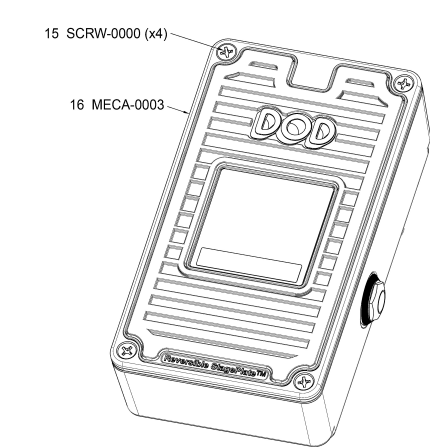

REPLACEMENT PARTS

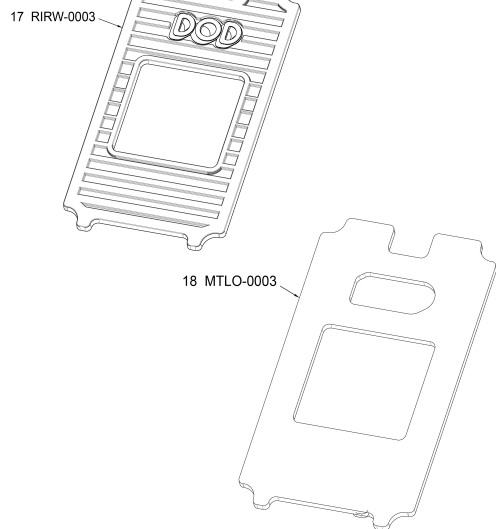

REPLACEMENT PARTS

- KNOB-0000** Large (26.5 mm) Shiny-Spiral Knob
- KNOB-0003** Bad Monkey Brewery (19 mm) Barrel Knob
- NUTT-0005** 5/16" Hex 1/4"-40 Nut (outside chassis)
- WSHR-0008** 1/4" Internal Tooth Lockwasher (outside chassis)
- MCCA-0001** LED Bezel Assembly (including bezel & internal split washer & internal nut)
- NUTT-0003** 10mm Hex M7x0.75 Nut for Potentiometers
- WSHR-0004** M7 Metal Flat Washer for Potentiometers
- KNOB-0002** Inner Concentric (11.5 mm) Shiny-Spiral Knob
- KNOB-0001** Outer Concentric (19 mm) Knob
- WSHR-0009** Black Plastic Decorative Beveled Washer for 1/4" Jacks
- NUTT-0006** 11mm Hex Chrome Threaded Ferrule for 1/4" Jacks
- NUTT-0004** 14mm Hex M12x0.75 Nut for Footswitch (one in-side, one outside)
- WSHR-0005** M12 Metal Flat Washer for Footswitch
- WSHR-0000** M12 Black Plastic Flat Washer for Footswitch
- SCRW-0000** 12mm M3x0.5 Phillips Flat Head Screw
- MECA-0003** StagePlate™ for DOD Side-Jack Chassis w/Skid Pad & Hook Material
- RIRW-0003** Replacement Adhesive-Backed Skid Pad for DOD Side-Jack Chassis
- MTLO-0003** Replacement Adhesive-Backed Hook Material for DOD Side-Jack Chassis
- NUTT-0002** 5/16" Hex 1/4"-40 Tall Spacer Nut (not shown – on toggle switch inside chassis)

*** DECLARATION OF CONFORMITY ***

This declaration has been issued under the sole responsibility of the manufacturer. The object of the declaration is in conformity with the relevant Union harmonization Legislation. For convenience, additional non-EU declarations are included within this Declaration of Conformity.

Manufacturer: DigiTech
Address: 6132 S 380 W
Murray, UT 84107
USA

DigiTech Headquarters
59 Hwagok-ro 61gil, Gangseo-gu
Seoul 07590
Republic of Korea

Declares that this product

Product SKU Number: DODBadderMonkey
Product Name: DOD Badder Monkey Overdrive
Product Options: All (requires an approved DigiTech Class II power adapter or equivalent that conforms to the requirements herein)

conforms to the following standards, specifications, and initiatives:

Safety: IEC 62368-1, 2nd & 3rd Editions
DOD SD-1995 JL FBC
EN 55032:2015+A1:2020, Class B
EN IEC 61000-3-2:2019+A2:2024
EN 61000-3-3:2013+A2:2021
EN 61000-4-2:2009
EN IEC 61000-4-3:2020
EN 61000-4-4:2012
EN 61000-4-5:2014+A1:2017
EN IEC 61000-4-6:2023
EN IEC 61000-4-11:2020
EN IEC 63000:2018
DOD 2023-CFEI

EMC: EN 55032:2015+A1:2020, Class B
EN IEC 61000-3-2:2019+A2:2024
EN 61000-3-3:2013+A2:2021
EN 61000-4-2:2009
EN IEC 61000-4-3:2020
EN 61000-4-4:2012
EN 61000-4-5:2014+A1:2017
EN IEC 61000-4-6:2023
EN IEC 61000-4-11:2020
EN IEC 63000:2018
DOD 2023-CFEI

RoHS: DOD 2023-CFEI
R&D: DOD 2023-CFEI

Supplementary information:

The product herewith complies with the requirements of the:

- Low Voltage Directive 2014/35/EU
- EMC Directive 2014/30/EU
- UK Statutory Instruments requirements, 2016 No. 1091, Electromagnetic Compatibility Regulations 2016
- RoHS Directive (EU) 2015/863, amending Annex II to Directive 2011/65/EU
- WEEE Directive 2012/19/EU
- ErP Directive 2009/125/EC, amended by energy efficiency Directive 2012/27/EU, and ecodesign Regulation (EU) 2019/1782

Roger T. Johnsen
VP of Engineering
September 24, 2025

DigiTech
6132 S 380 W
Murray, UT 84107
USA

Contact: Your local DigiTech sales office, or visit the DigiTech website at www.digitech.com, or contact:

COR-TEX Corp.
59 Hwagok-ro 61gil, Gangseo-gu
Seoul 07590
Republic of Korea
support@digitech.com

DigiTech

CAUTION
RISK OF ELECTRIC SHOCK
DO NOT OPEN

ATTENTION: RISQUE DE CHOC ELECTRIQUE - NE PAS OUVRIR

WARNING: TO REDUCE THE RISK OF FIRE OR ELECTRIC SHOCK DO NOT EXPOSE THIS EQUIPMENT TO RAIN OR MOISTURE

These symbols are internationally accepted symbols that warn of potential hazards with electrical products. The lightning flash means that there are dangerous voltages present within the unit. The exclamation point indicates that it is necessary for the user to refer to the owner's manual.

These symbols warn that there are no user serviceable parts inside the unit. Do not open the unit. Do not attempt to service the unit yourself. Refer all servicing to qualified personnel. Opening the chassis for any reason will void the manufacturer's warranty. Do not get the unit wet. If liquid is spilled on the unit, shut it off immediately and take it to a dealer for service.

Disconnect the unit during storms to prevent damage.

Warning

For your protection, please read the following:

Important Safety Instructions

- Read these instructions.
- Keep these instructions.
- Heed all warnings.
- Do not use this apparatus near water.
- Clean only with dry cloth.
- Do not block any ventilation openings. Install in accordance with the manufacturer's instructions.
- Do not install near any heat sources such as radiators, heat registers, stoves, or other apparatus (including amplifiers) that produce heat.
- Protect the power cord from being walked on or pinched particularly at plugs, convenience receptacles, and the point where they exit from the apparatus.
- Unplug this apparatus during lightning storms or when unused for long periods of time.
- No user serviceable parts inside. Refer all servicing to qualified service personnel. Servicing is required when the apparatus has been damaged in any way, such as power-supply cord or plug is damaged, liquid has been spilled or objects have fallen into the apparatus, the apparatus has been exposed to rain or moisture, does not operate normally, or has been dropped.
- WARNING: To reduce the risk of fire or electric shock, do not expose this apparatus to rain or moisture.
- Refer to labels on the unit, including bottom cover, or other markings and pertinent information.