

The FX 59 Thrash Master screams over the edge with overwhelming distortion and super-edgy tone for raging speed freaks who only live for hyperspeed solos and warp-speed beat. For dealers in death and destruction only.

CONNECTING THE FX 59 THRASH MASTER

Connect the INPUT of the FX 59 to your guitar with a 1/4-inch mono phone plug. Connect the OUTPUT of the FX 59 to your amplifier (or to the input of other effects if you're using them) with a 1/4-inch mono phone plug. To eliminate the need for a 9 volt battery, attach either the DOD PS 3 or the DOD FX 105 power supply to the 3.5 mm A.C. adapter jack.

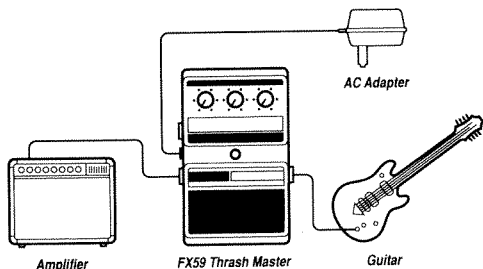

FEATURES

- FET switching for "clickless" insertion into the signal path
- LED indicator shows the status of the effect and battery condition
- No tools, easy access battery compartment
- Adapter jack for A.C. operation
- Rugged die cast metal case
- Three year limited warranty
- Rubber non-skid bottom

CONTROLS

LEVEL: Adjusts the level of the distorted signal compared to the level of the "dry" signal.

PRESENCE: Adjusts the level of treble added to the distorted signal.

DISTORTION: Adjusts the level of distortion.

FOOTSWITCH: Switches the distortion effect IN/OUT of the signal path.

LED INDICATOR: Lights up when the distortion is enabled.

JACKS: INPUT, OUTPUT, A.C. ADAPTER.

IMPORTANT NOTES

- Unplug input jack when not in use.
- LED will dim and distortion will be present when the battery is depleted.

EFFECTS CHAIN

A stereo multiple effects setup using the FX 59 might look like this:

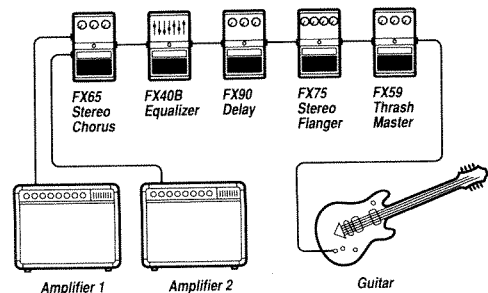

CHANGING THE BATTERY

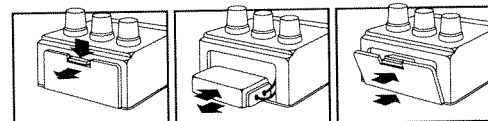

Figure 1

Figure 2

Figure 3

Figure 1: Push tab down and pull out at top
 Figure 2: Remove battery and replace as shown
 Figure 3: Insert cover in groove and push closed

Use Eveready® #216 zinc or Eveready® #522 alkaline batteries.