



Mini Volume Pedal Owner's Manual

Thanks for purchasing the DOD® Mini Volume Pedal, the miniature passive volume pedal that gives you a full range of volume control, without robbing you of valuable pedalboard space.

Features:

- Small form factor occupies minimal pedalboard space
- Long-throw treadle for full range of control
- High-quality, high-cycle 500k Ω potentiometer for smooth volume adjustments
- Built-in treble bleed circuit prevents loss of treble at lower volume settings
- Removable rubber feet for pedalboard mounting
- 1/4" TS input and output jacks
- Skid-free treadle pad
- Rugged construction

Setup:

1. Turn your amp off, then connect your cables (see connection diagram below).
2. Turn your amp volume down, push the DOD Mini Volume Pedal's treadle toe down, then turn your amp on.
3. Slowly raise your amp volume until the desired level is reached.

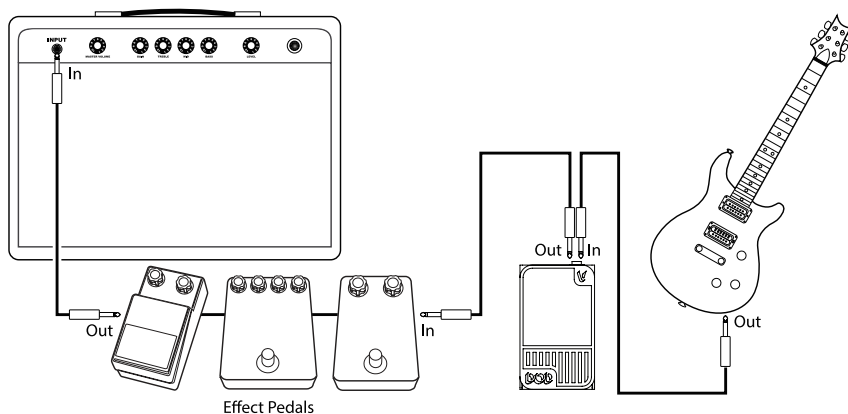

Use only unbalanced TS cables.

****IMPORTANT USAGE NOTE****

The two hex screws on the bottom of the pedal are part of a spring-loaded adjustment mechanism. If over time you experience slop, loosen these screws slightly and then re-tighten. This will cause the main engagement gear to re-tighten against the treadle gear.

DO NOT remove these screws or operate the treadle while the screws are loosened. This can cause the gears to become misaligned and cause the pedal to malfunction. **There are no user-adjustable components inside the pedal. Under no circumstances should the pedal be opened up.**

DECLARATION OF CONFORMITY

Manufacturer's Name: DOD
Manufacturer's Address: 59 Hwagok-ro 61gil, Gangseo-gu
Seoul 07590, Republic of Korea

Declares that the product:

Product name: DOD Mini-Volume

Product option: None

Conforms to the following Product Specifications:

Safety: N/A – no power

EMC: Analog Products

The DOD Mini-Volume and Mini-Expression pedals by design provide an adequate level of intrinsic immunity as called out in EN55024. By following good engineering practices and engineering rational Harman declares that by design these pedals will provide an adequate level of intrinsic immunity and will operate as intended in their environment.

Supplementary Information:

The product herewith complies with the requirements of the:

Low Voltage Directive 2006/95/EC

EMC Directive 2004/108/EC

RoHS Directive 2011/65/EC

WEEE Directive 2002/96/EC

EC Regulation 278/2009

European: Your local DigiTech Sales and Service Office or

CORTEK Corp.

59 Hwagok-ro 61gil, Gangseo-gu Seoul

07590, Republic of Korea

support@digitech.com

DÉCLARATION DE CONFORMITÉ

Nom du fabricant : DOD
Adresse du fabricant : 59 Hwagok-ro 61gil, Gangseo-gu
Seoul 07590, Republic of Korea

déclare que le produit :

Nom du produit : DOD Mini-Volume

Option du produit : Aucune

est conforme aux spécifications suivantes :

Sécurité : S/0 – sans pouvoir

CEM : Produits Analogiques

Les pédales DOD Mini-Volume et Mini-Expression par conception fournissent un niveau adéquat d'immunité intrinsèque tel qu'indiqué dans EN55024. En suivant les bonnes pratiques d'ingénierie et l'ingénierie rationnelle, Harman déclare que, grâce à la conception, ces pédales fourniront un niveau adéquat d'immunité intrinsèque et fonctionneront comme prévu dans leur environnement.

Informations complémentaires :

Ce produit est conforme aux exigences suivantes :

Directive sur la basse tension 2006/95/CE

Directive CEM 2004/108/CE

Directive RoHS 2011/65/CE

Directive DEEE 2002/96/CE

Règlement 278/2009 de l'CE

Contact : Votre bureau local de vente et de service DigiTech ou

CORTEK Corp.

59 Hwagok-ro 61gil, Gangseo-gu

Seoul 07590, Republic of Korea

support@digitech.com

COMPLIANCE & SAFETY INSTRUCTIONS



The following is indicative of low altitude use; do not use this product above 2000m.



The symbols shown above are internationally accepted symbols that warn of potential hazards with electrical products. The lightning flash with arrowpoint in an equilateral triangle means that there are dangerous voltages present within the unit. The exclamation point in an equilateral triangle indicates that it is necessary for the user to refer to the owner's manual.

These symbols warn that there are no user serviceable parts inside the unit. Do not open the unit. Do not attempt to service the unit yourself. Refer all servicing to qualified personnel. Opening the chassis for any reason will void the manufacturer's warranty. Do not get the unit wet. If liquid is spilled on the unit, shut it off immediately and take it to a dealer for service. Disconnect the unit during storms to prevent damage.

U.K. MAINS PLUG WARNING

A molded mains plug that has been cut off from the cord is unsafe. Discard the mains plug at a suitable disposal facility.

NEVER UNDER ANY CIRCUMSTANCES SHOULD YOU INSERT A DAMAGED OR CUT MAINS PLUG INTO A 13 AMP POWER SOCKET.

Do not use the mains plug without the fuse cover in place. Replacement fuse covers can be obtained from your local retailer. Replacement fuses are 13 amps and MUST be ASTA approved to BS1362.



If you want to dispose this product, do not mix it with general household waste. There is a separate collection system for used electronic products in accordance with legislation that requires proper treatment, recovery and recycling.

Private households in the 25 member states of the EU, in Switzerland and Norway may return their used electronic products free of charge to designated collection facilities or to a retailer (if you purchase a similar new one). For Countries not mentioned above, please contact your local authorities for a correct method of disposal. By doing so you will ensure that your disposed product undergoes the necessary treatment, recovery and recycling and thus prevent potential negative effects on the environment and human health.

WARNING FOR YOUR PROTECTION READ THE FOLLOWING:

READ THESE INSTRUCTIONS.

KEEP THESE INSTRUCTIONS.

HEED ALL WARNINGS.

FOLLOW ALL INSTRUCTIONS.

DO NOT USE THIS APPARATUS NEAR WATER.

CLEAN ONLY WITH A DRY CLOTH.

FOR INDOOR USE ONLY.

DO NOT BLOCK ANY OF THE VENTILATION OPENINGS. INSTALL IN ACCORDANCE WITH THE MANUFACTURER'S INSTRUCTIONS.

DO NOT INSTALL NEAR ANY HEAT SOURCES SUCH AS RADIATORS, HEAT REGISTERS, STOVES, OR OTHER APPARATUS (INCLUDING AMPLIFIERS) THAT PRODUCE HEAT.

ONLY USE ATTACHMENTS/ACCESSORIES SPECIFIED BY THE MANUFACTURER.

UNPLUG THIS APPARATUS DURING LIGHTNING STORMS OR WHEN UNUSED FOR LONG PERIODS OF TIME.

Do not defeat the safety purpose of the polarized or grounding-type plug. A polarized plug has two blades with one wider than the other. A grounding type plug has two blades and a third grounding prong. The wide blade or third prong are provided for your safety. If the provided plug does not fit your outlet, consult an electrician for replacement of the obsolete outlet.

Protect the power cord from being walked on or pinched particularly at plugs, convenience receptacles, and the point where they exit from the apparatus.

Use only with the cart stand, tripod bracket, or table specified by the manufacture, or sold with the apparatus. When a cart is used, use caution when moving the cart/apparatus combination to avoid injury from tip-over.



Refer all servicing to qualified service personnel. Servicing is required when the apparatus has been damaged in any way, such as power-supply cord or plug is damaged, liquid has been spilled or objects have fallen into the apparatus, the apparatus has been exposed to rain or moisture, does not operate normally, or has been dropped.

POWER ON/OFF SWITCH: The Power switch used in this piece of equipment DOES NOT break the connection from the mains.

MAINS DISCONNECT: The plug shall remain readily operable. For rack-mount or installation where plug is not accessible, an all-pole mains switch with a contact separation of at least 3 mm in each pole shall be incorporated into the electrical installation of the rack or building.

If connected to 240V supply, a suitable CSA/UL certified power cord shall be used for this supply.

SAFETY INSTRUCTIONS

NOTICE FOR CUSTOMERS IF YOUR UNIT IS EQUIPPED WITH A POWER CORD.

WARNING: THIS APPLIANCE SHALL BE CONNECTED TO A MAINS SOCKET OUTLET WITH A PROTECTIVE EARTHING CONNECTION.

THE CORES IN THE MAINS LEAD ARE COLOURED IN ACCORDANCE WITH THE FOLLOWING CODE:

GREEN AND YELLOW – EARTH / BLUE – NEUTRAL / BROWN - LIVE

AS COLOURS OF THE CORES IN THE MAINS LEAD OF THIS APPLIANCE MAY NOT CORRESPOND WITH THE COLOURED MARKINGS IDENTIFYING THE TERMINALS IN YOUR PLUG, PROCEED AS FOLLOWS:

! THE CORE WHICH IS COLOURED GREEN AND YELLOW MUST BE CONNECTED TO THE TERMINAL IN THE PLUG MARKED WITH THE LETTER E, OR WITH THE EARTH SYMBOL, OR COLOURED GREEN, OR GREEN AND YELLOW.

! THE CORE WHICH IS COLOURED BLUE MUST BE CONNECTED TO THE TERMINAL MARKED N OR COLOURED BLACK.

! THE CORE WHICH IS COLOURED BROWN MUST BE CONNECTED TO THE TERMINAL MARKED L OR COLOURED RED.

THIS EQUIPMENT MAY REQUIRE THE USE OF A DIFFERENT LINE CORD, ATTACHMENT PLUG, OR BOTH, DEPENDING ON THE AVAILABLE POWER SOURCE AT INSTALLATION. IF THE ATTACHMENT PLUG NEEDS TO BE CHANGED, REFER SERVICING TO QUALIFIED SERVICE PERSONNEL WHO SHOULD REFER TO THE TABLE BELOW. THE GREEN/YELLOW WIRE SHALL BE CONNECTED DIRECTLY TO THE UNITS CHASSIS.

| CONDUCTOR | | WIRE COLOR | |
|-----------|-----------|------------|-------|
| | | Normal | Alt |
| L | LIVE | BROWN | BLACK |
| N | NEUTRAL | BLUE | WHITE |
| E | EARTH GND | GREEN/YEL | GREEN |

WARNING: IF THE GROUND IS DEFEATED, CERTAIN FAULT CONDITIONS IN THE UNIT OR IN THE SYSTEM TO WHICH IT IS CONNECTED CAN RESULT IN FULL LINE VOLTAGE BETWEEN CHASSIS AND EARTH GROUND. SEVERE INJURY OR DEATH CAN THEN RESULT IF THE CHASSIS AND EARTH GROUND ARE TOUCHED SIMULTANEOUSLY.